

ARCHITECTURAL DESIGN STUDIOS METU

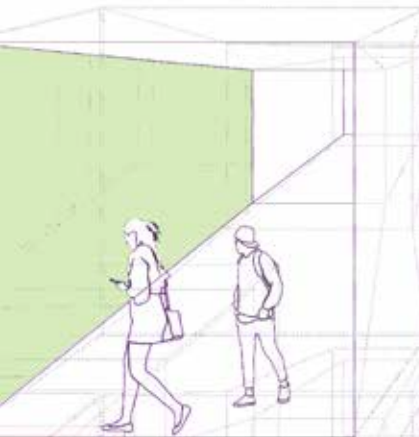

spring | 2023-2024 final juries



ARCH 102

Introduction to Architectural Design

Jury: 29 May 2024, at 9:30

Architectural Responses to Sinop's Ecologies

Funda Bař Bütüner
Ayřem Berrin akmaklı
Esin Kömez Dađlıođlu
Ekin Pinar
Sinan Cem Kızıl
Aya Nilüfer alıkuřu
Eser Delice
Ertuđ Erpek
Dilara Güney
Orun Sena Saracođlu
Elif Göken Tepekaya
Feyza Topuođlu

Guest Members:

Yiđit Acar (Bilkent U.)
Nesli Naz Aksu (TOBB ETU)
Emre Erkal
Buket Samancı (MEF FADA)
Deniz Uygur
řenol Yađız
Onur Yüncü (TEDU)

Faculty Members:

Ela Alanyalı Aral
Güven Arif Sargın
Pelin Yoncacı Arslan
Caner Arıkbođa
Bengisu Derebařı
Nesrin Erdođan
Beste Fakıođlu
Sezin Sarıca
Göke Nihan Tařkın
Hüseyin Polat
Dilara Yarař Er
Bařak Tükenmez

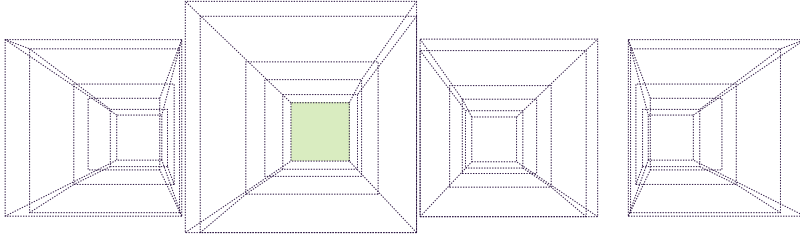

ARCH 202

Architectural Design II

Jury: 30-31 May 2024, at 9:30

PROTECT: REFLECTIONS ON CLIMATE CHANGE

Group I:

İnci Basa, Güven Arif Sargın, Orhan Uludağ,
Yusuf Bera Bilici, Berre Özkoç

Faculty Members:

Ayşen Savaş Sargın, Ayşem Berrin Çakmaklı,
Bengisu Derebaşı, Eser Delice

Guest Members:

Aysu Berk (Bilkent U.)
Begüm Peker (Bilkent U.)

@Second Year Studio

Group II:

Ela Alanyalı Aral, Gizem Deniz Güneri, Tuğba Özer,
Hüseyin Polat, Semih Solak

Faculty Members:

Funda Baş Bütüner, Bekir Özer Ay,
Ertuğ Erpek, Feyza Topçuoğlu

Guest Members:

Emre Erkal, Gamze Demiröz İlanan (Atılım U.)
Cem Dedekarginoğlu (Bilkent U.)

@ Second Year Studio

Group III:

Koray Pekerçli, Can Uraz,
Caner Arıkboğa, Ayşen Çerşil

Faculty Members:

Celal Abdi Güzer, Aydan Balamir,
Gizem Nur Aydemir, Ayça Nilüfer Çalikuşu

Guest Members:

Deniz Üçer (Bilkent U.)
Dicle Kumararslan (Bilkent U.)
Esatcan Coşkun (TEDU)

@ Second Year Studio

Group IV:

Turhan Kayasü, Fatih Topak, Özgür Ürey,
Sezin Sarıca, Öncü Özalp

Faculty Members:

Cânâ Bilsel, Esin Kömez Dağlıoğlu,
Serda Buket Erol, Mustafa Eren Bük

Guest Members:

Dirim Dinçer (TU Delft)
Aktan Acar (TOBB ETU)

@ Second Year Studio

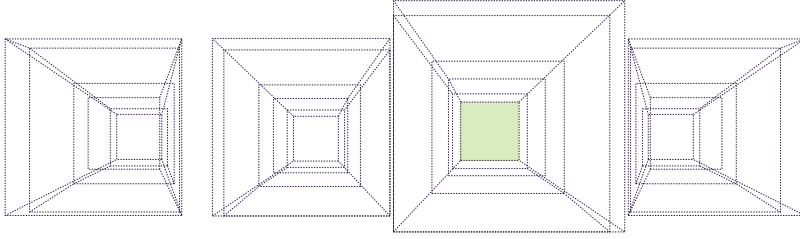

ARCH 302

Architectural Design IV

Jury: 30-31 May 2024

Group I:

A CULTURAL CENTER IN SİNOP

Haluk Zelef, Yavuz Özkaya,
Elif Bekar, Seda Cengiz

Faculty Members:

Miray Kısaer Koca, Sinan Cem Kızıl,
Nadide Gür

Guest Members:

Cengiz Kabaoğlu, Neşe Gurallar (TEDU),
Hülya Cilvez Andaç (Sinop Belediyesi),
Serkan Ustaoglu (Fatih Sultan Mehmet Vakıf Üniversitesi),
Emrah Köşgeroğlu, Umut Bilgiç

@ Third Year Studio, 09:30

Group II:

A PUBLIC LIBRARY IN ANKARA

Ali Osman Öztürk, Süreyya Atalay,
Nihan Büşra Kezer, Dilara Yaraş Er

Faculty Members:

Pelin Yoncacı Arslan, Elif Gökçen Tepekaya,
Selin Tosun, Melis Erdem

Guest Members:

Namık Erkal (TEDU), Yiğit Acar (Bilkent U.),
Zühre Sü Gül (Bilkent U.), Duygu Tüntaş (TEDU)

@Göbektaşı, 10:40

Group III:

RETHINKING KONYA CER ATELIER AS AN URBAN CATALYST

Hasan Okan Çetin, Meral Özdengiz Başak,
Merve Öztürk, Başak Tükenmez

Faculty Members:

Pınar Aykaç Leidholm, Özgün Özçakır,
Pınar Gökçınar Balkan, Cansu Ekici, Dilara Güney

Guest Members:

Eren Başak, Ezgi İşbilen (Bilkent U.),
Kadri Atabaş

@ Third Year Studio, 09:30

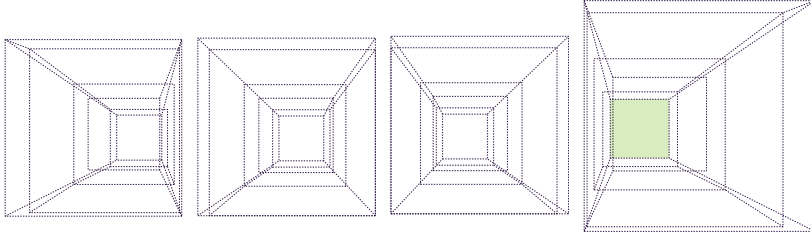

ARCH 402

Architectural Design VI

Jury: 3-4 June 2024, 09:30

Group I:

Critical Challenges at the Human-Technology Frontier: Research Ecosystems for Locally Resilient Societies, Kocaeli Nexus of Technology and Fabrication

Celâl Abdi Güzer, Lale Özgenel, Kadri Atabaş,
E. Hazal Türkyılmaz Bilgiç, Melis Erdem, Nadide Gür

Faculty Members:

Hasan Okan Çetin, Orçun Sena Saracoğlu,
Öncü Özalp, Nihan Büşra Kezer

Guest Members:

Sinem Çınar (Atılım U.), Yiğit Acar (Bilkent U.),
Özge Selen Duran (Bilkent U.), Yakup Hazan,
Güneş Gökçek, Kutlu Bal, Aysin Sevgi Karakurt,
Oktan Nalbantoğlu (Bilkent U.)

@Fourth Year Studio

Group III:

RECOVERY OF ANTAKYA VIA ARTS AND POLITICS

Cânâ Bilsel, Zeynep Mennan, Aydan Balamir, Murat Çetin,
Mustafa Eren Bük, Selin Tosun

Faculty Members:

İnci Basa, Haluk Zelef, Gizem Deniz Güneri, Özgün Özçakır,
Elif Gökçen Tepekaya, Caner Arıkboğa, Semih Solak,
Yusuf Bera Bilici

Guest Members:

Alişan Çırakoğlu, Kerem Yazgan,
Burak Bican (Atılım U.)

@Fourth Year Studio

Group II:

URLA QUARANTINE ISLAND: POST-TRAUMA CENTER

Ayşen Savaş Sargın, Arzu Gönenç Sorguç, Emre Erkal,
Serda Buket Erol, Bengisu Derebaşı

Faculty Members:

Güven Arif Sargın, Funda Baş Bütüner, Sinan Cem Kızıl,
Müge Kruşa Yemişçioğlu, Pınar Gökçınar Balkan,
Berre Özkoç, Elif Bekar

Guest Members:

Onur Yüncü (TEDU), Nesli Naz Aksu (TOBB ETU),
Kerem Yazgan, Alper Aytaç,
Sevince Bayrak, Alper Derinboğaz,
Kemal Serkan Demir

Advisor Members:

Ali Armağan Daloğlu (Müze Kumbaram)
Özlem Dengiz Uğur (Müze Kumbaram)
Yaşar Erkan Ersoy (Yaşar U./Archaeology)

@Second Year Studio

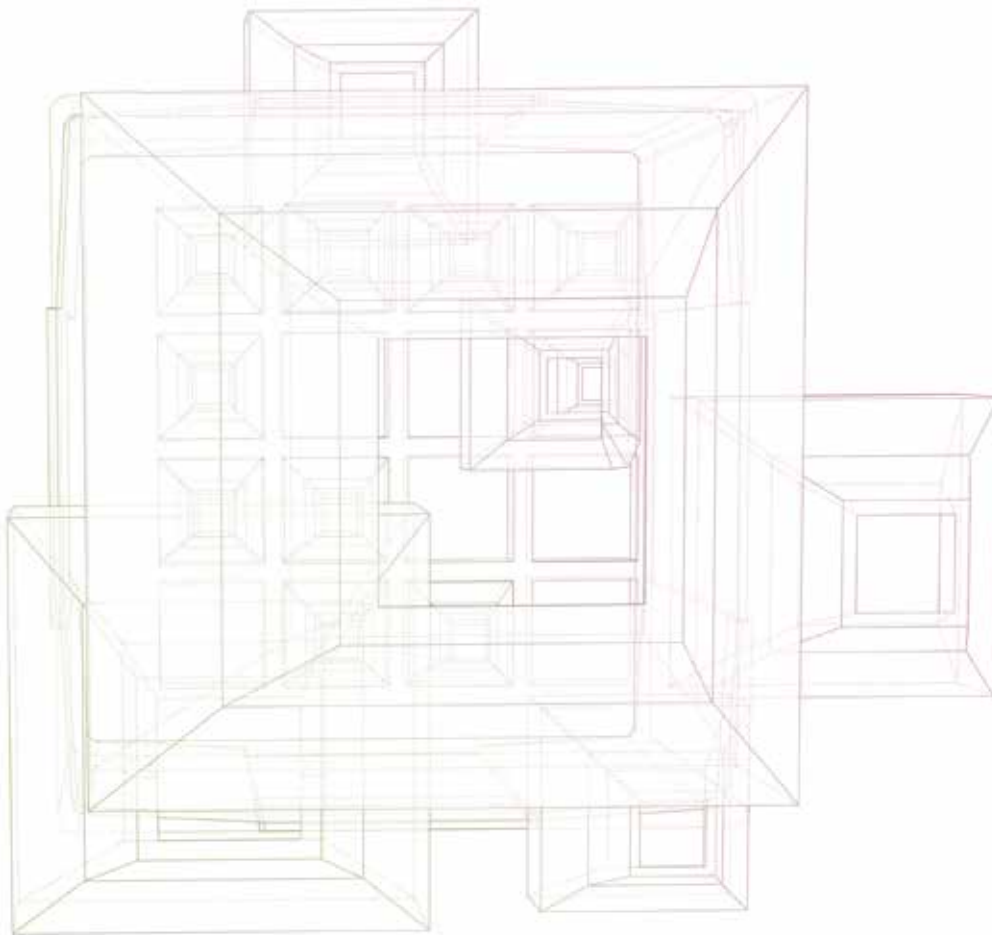

reminders

Students are expected to attend the juries and follow the discussions on the designs presented by their classmates. It is further recommended that they attend juries held in other groups and classes as well.

Please be reminded that juries are final exams and that late-submissions will be evaluated accordingly.

Officially scheduled curricular activities at METU are required to be in English. Both students and jury members are kindly reminded of this requirement.